

# Raccords universels en acier inoxydable DIN 2353

## Stainless steel compression fittings DIN 2353

### Schneidringverschraubungen aus Edelstahl DIN 2353

#### Champs d'application : air comprimé, huile, eau, chimie

Caractéristiques techniques

- corps en acier inoxydable AISI 316ti
- conforme à la norme DIN 2353/ISO 8434-1
- filetages : mâle conique BSP / NPT  
mâle cylindrique BSP  
femelle cylindrique BSP
- pression maximale de service :  
voir tableau ci-dessous
- température de travail : -150°C ÷ 400°C  
dépend des caractéristiques du tube utilisé

#### Areas of application : compressed air, hydraulic, water, chemical

Technical features

- stainless steel AISI 316ti construction
- in conformity with DIN 2353 / ISO 8434-1
- threads : male taper BSP / NPT  
male parallel BSP  
female parallel BSP
- maximum working pressure :  
see undermentioned board
- working temperature : -150°C ÷ 400°C  
depends on the feature of the selected pipe

#### Anwendungsbereiche : Druckluft, Hydraulisch, Wasser, Chemie

Technische Daten

- Gehäuse aus Edelstahl 1.4571
- entsprechend DIN 2353 / ISO 8434-1
- Gewinde : Außen kegelig BSP / NPT  
Außen zylindrisch BSP  
Innen zylindrisch BSP
- maximaler Betriebsdruck : untengenannt
- Betriebstemperatur : -150°C ÷ 400°C  
wird von den Eigenschaften der verwendeten  
Rohren bestimmt



#### Pression maximale de service à 20°C du raccordement:

Maximum working pressure at 20°C  
Maximaler Betriebsdruck (20°C)

Ø TUBE (mm)	6	8	10	12	15	16	22
Rac. coniques (bar)	250	250	250	250	250	400	100
Rac. de jonction (bar)	500	500	500	400	400	630	250

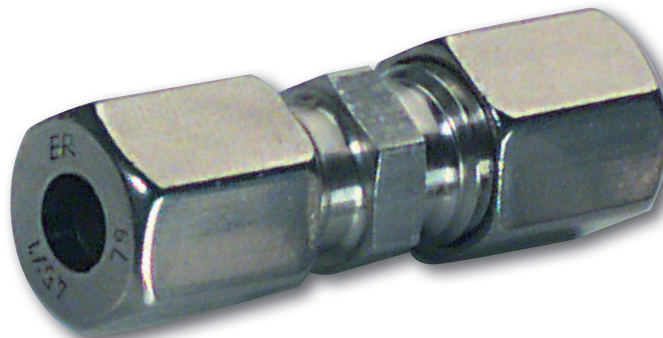
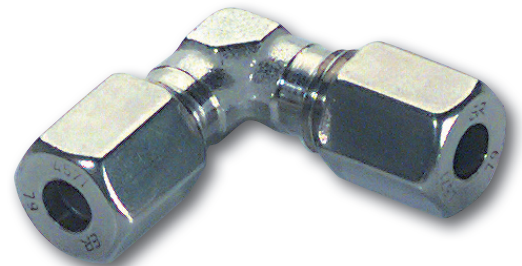
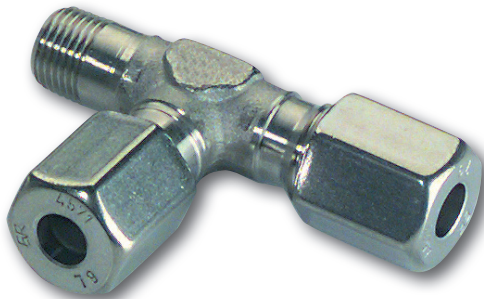

# Raccords d'implantation

## Implantation's fittings

### Einschraub-Steckverschraubungen

**INOX**

#### DROIT MÂLE CONIQUE BSP / NPT

MALE STRAIGHT FITTING, TAPER BSP / NPT

GERADE EINSCHRAUBVERSCHRAUBUNG - KEGELIG BSP / NPT

## 1700

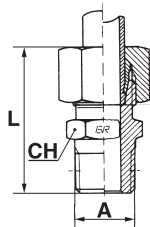

TYPE	TUBE	A	L	CH
<b>CODE</b>				
1700 06 10	6	1/8	31	12
1700 06 13	6	1/4	35	14
1700 08 10	8	1/8	31	14
1700 08 13	8	1/4	35	17
1700 08 17	8	3/8	35	19
1700 10 13	10	1/4	36,5	17
1700 10 17	10	3/8	36,5	17
1700 10 21	10	1/2	38,5	22
1700 12 13	12	1/4	37,5	19
1700 12 17	12	3/8	37,5	19
1700 12 21	12	1/2	39,5	22
1700 15 21	15	1/2	41	24
1701 16 21*	16	1/2	51	27
1700 22 27	22	3/4	46	32

\* cylindrique avec joint VITON.

\* parallel with VITON O-ring

\* zylindrisch mit VITON O-ring



#### DROIT FEMELLE CYLINDRIQUE

FEMALE STRAIGHT FITTING, PARALLEL

GERADE AUFSCHRAUBVERSCHRAUBUNG - ZYLINDRISCH

## 1703

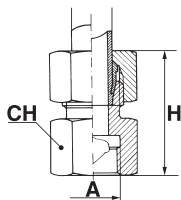
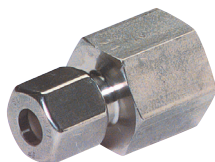

TYPE	TUBE	A	H	CH
<b>CODE</b>				
1703 06 10	6	1/8	34	14
1703 06 13	6	1/4	39	19
1703 08 13	8	1/4	39	19
1703 08 17	8	3/8	40	24
1703 10 17	10	3/8	41	24
1703 12 17	12	3/8	41	24

#### ÉQUERRE MÂLE ORIENTABLE CYLINDRIQUE AVEC JOINT FKM MONTÉ

SWIVEL MALE ELBOW FITTING, PARALLEL WITH FKM SEALING

WINKLEINSCHRAUBVERSCHRAUBUNG, SCHWENKBAR-ZYLINDRISCH MIT FKM O-RING

## 1706

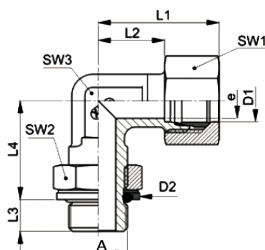

TYPE	TUBE	A	D2	L1	L2	L3	L4	SW1	SW2	SW3
<b>CODE</b>										
1706 06 10	6	1/8	15,0	29	14	7	19	14	14	12
1706 08 13	8	1/4	19,5	31	16	9	23	17	19	12
1706 10 13	10	1/4	19,5	32	17	9	25	19	19	14
1706 12 17	12	3/8	23,5	34	19	9	28	22	22	17
1706 15 21	15	1/2	28,5	36	21	13	30	27	27	19

### ÉQUERRE MÂLE CONIQUE

ELBOW MALE FITTING, TAPER

WINKEL EINSCHRAUBVERSCHRAUBUNG - KEGELIG

## 1710

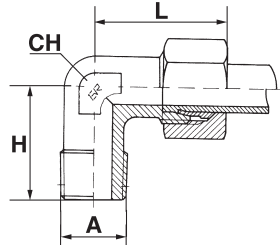

TYPE	TUBE	A	H	L	CH
<b>CODE</b>					
1710 06 10	6	1/8	20	27	12
1710 06 13	6	1/4	26	27	12
1710 08 10	8	1/8	26	29	12
1710 08 13	8	1/4	26	29	12
1710 10 13	10	1/4	27	30,5	14
1710 10 17	10	3/8	27	30,5	14
1710 12 17	12	3/8	28	32,5	17
1710 12 21	12	1/2	32	36,5	17
1710 16 21	16	1/2	32	44	24

### RACCORD EN T PIQUAGE CENTRAL MÂLE CONIQUE

CENTRAL T MALE FITTING, TAPER

ZENTRALE T-EINSCHRAUBVERSCHRAUBUNG - KEGELIG

## 1708

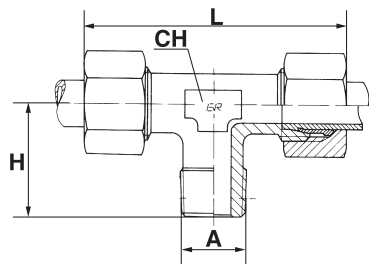
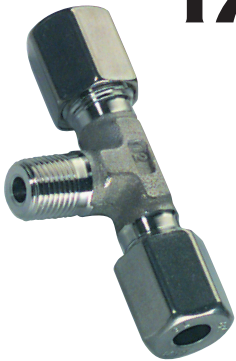

TYPE	TUBE	A	H	L	CH
<b>CODE</b>					
1708 06 10	6	1/8	20	54	12
1708 08 13	8	1/4	26	58	12
1708 10 13	10	1/4	27	61	14
1708 12 17	12	3/8	28	65	17
1708 16 21	16	1/2	32	88	24

### RACCORD EN T PIQUAGE LATÉRAL MÂLE CONIQUE

OFF-SET T MALE FITTING, TAPER

LATERALE T-EINSCHRAUBVERSCHRAUBUNG - KEGELIG

## 1712

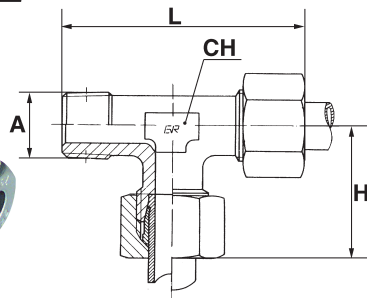
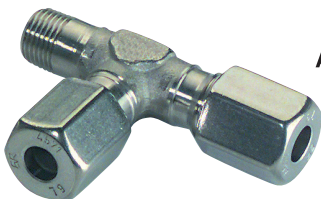

TYPE	TUBE	A	H	L	CH
<b>CODE</b>					
1712 06 10	6	1/8	27	40	12
1712 08 13	8	1/4	29	52	12
1712 10 13	10	1/4	30	54	14
1712 12 17	12	3/8	32	56	17
1712 16 21	16	1/2	43	64	24

# Raccords de jonction

## Junction's fittings

### Verbindungsverschraubungen

**INOX**

#### DROIT DOUBLE

INTERMEDIATE STRAIGHT FITTING  
GERADER VERBINDER

## 1702

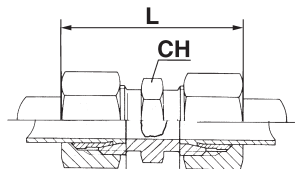

TYPE	TUBE	L	CH
<b>CODE</b>			
1702 06 00	6	40	12
1702 08 00	8	41	14
1702 10 00	10	44	17
1702 12 00	12	45	19
1702 16 00	16	60	27

TYPE	TUBE	L	CH
<b>CODE</b>			
1702 08 06	8-6	41	14
1702 10 08	10-8	42	17
1702 12 10	12-10	44	19

#### ÉQUERRE DOUBLE

INTERMEDIATE ELBOW FITTING  
WINKELVERBINDER

## 1707

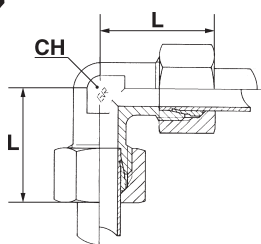
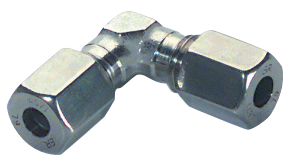

TYPE	TUBE	L	CH
<b>CODE</b>			
1707 06 00	6	27	12
1707 08 00	8	29	12
1707 10 00	10	30	14
1707 12 00	12	32	17
1707 16 00	16	44	24

#### RACCORD EN T TRIPLE

INTERMEDIATE T FITTING  
T-VERBINDER

## 1714

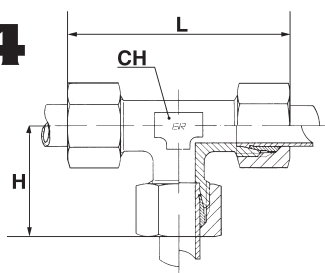
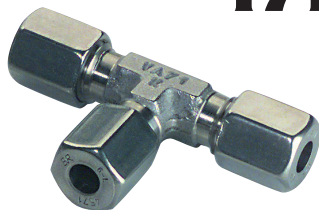

TYPE	TUBE	H	L	CH
<b>CODE</b>				
1714 06 00	6	27	54	12
1714 08 00	8	29	58	12
1714 10 00	10	30	60	14
1714 12 00	12	32	65	17
1714 16 00	16	43	88	24

#### TRAVERSÉE DE CLOISON DOUBLE

INTERMEDIATE BULKHEAD FITTING  
SCHOTT - VERSCHRAUBUNG

## 1716

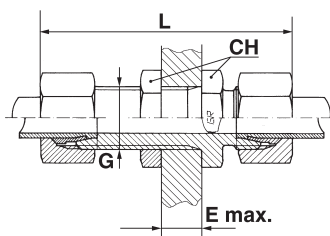

TYPE	TUBE	L	G	E <sub>max</sub>	CH
<b>CODE</b>					
1716 06 00	6	64	M12x1,5	22	17
1716 08 00	8	65	M14x1,5	23	19
1716 10 00	10	68	M16x1,5	23	22
1716 12 00	12	69	M18x1,5	24	24

## ÉCROU DE SERRAGE

LOCKING NUT  
ÜBERWURFMUTTER

### 1730

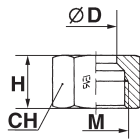

TYPE	D	H	M	CH
<b>CODE</b>				
1730 06 00	6	14,5	M12x1,5	14
1730 08 00	8	14,5	M14x1,5	17
1730 10 00	10	15,5	M16x1,5	19
1730 12 00	12	15,5	M18x1,5	22
1730 15 00	15	17	M22x1,5	27
1730 16 00	16	20,5	M24x1,5	30

## BAGUE

OGIVE SEAL  
SCHNEIDRING

### 1729

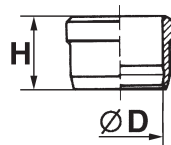

TYPE	D	H
<b>CODE</b>		
1729 06 00	6	9
1729 08 00	8	9
1729 10 00	10	10
1729 12 00	12	10
1729 15 00	15	10
1729 16 00	16	10,5

## FOURRURE DE RENFORT

FERRULE  
VERSTÄRKUNGSHÜLSE

### 1731

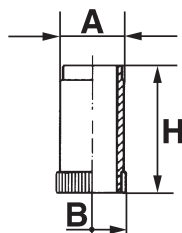

TYPE	TUBE	A	B	H
<b>CODE</b>				
1731 06 00	6/4	3,8	4,5	15,5
1731 08 00	8/6	5,8	6,5	15,5
1731 10 00	10/8	7,5	8,5	17
1731 12 00	12/10	9,8	10,2	17
1731 16 13	16/13	12,8	13,2	18

## BLOC DE PRÉ-SERTISSAGE MANUEL

ADAPTOR FOR MANUAL PRE-ASSEMBLY  
HAND-VORMONTAGESTUTZEN

### 1789

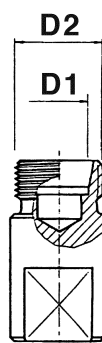

TYPE	D1	D2
<b>CODE</b>		
1789 06 00	6	M12x1,5
1789 08 00	8	M14x1,5
1789 10 00	10	M16x1,5
1789 12 00	12	M18x1,5
1789 15 00	15	M22x1,5
1789 16 00	16	M24x1,5

