

Raccords universels à bague bicône

Universal double cone fittings

Universal-Verschraubungen

Champs d'application : air comprimé, huile, eau

Caractéristiques techniques

- construction en laiton
- tube : indication du diamètre extérieur
- filetages : cylindrique BSP avec joint ou rondelle conique BSP
- pression maximale de service: voir tableau ci-dessous
- température de travail : -40° ÷ 100°C

Areas of application : compressed air, hydraulic, water

Technical features

- brass construction
- hose : indication of the external diameter
- threads : parallel BSP with O-ring / washer taper BSP
- maximum working pressure : see undermentioned board
- working temperature : -40° ÷ 100°C

Anwendungsbereiche : Druckluft, Hydraulisch, Wasser

Technische Daten

- Messinggehäuse
- Schläuche : Außendurchmesser angegeben
- Gewinde : zylindrisch BSP mit O-ring / Dichtring kegelig BSP
- maximaler Betriebsdruck : unten genannt
- Betriebstemperatur : -40° ÷ 100°C



Pression maximale de service à 20°C du raccordement:

Maximum working pressure at 20°C

Maximaler Betriebsdruck (20°C)

Ø TUBE (mm)	4	6	8	10	12	14	15	16	18	22
Tube cuivre (bar)*	220	150	100	70	50	40	40	40	35	30
Tube polyamide	voir documentation des tubes polyamide									

* écroui, étiré à froid (recuit : non)

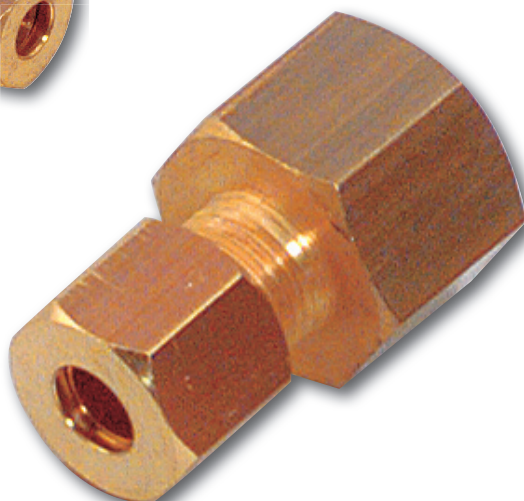
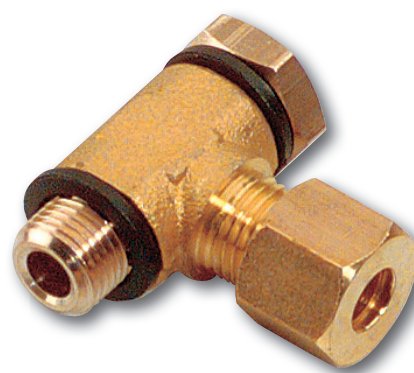
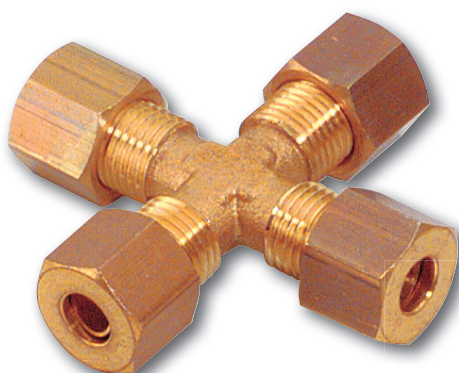

Raccords d'implantation

Implantation's fittings

Einschraub-Steckverschraubungen

DROIT MÂLE CONIQUE

MALE STRAIGHT FITTING, TAPER

GERADE EINSCHRAUBVERSCHRAUBUNG - KEGELIG

1300

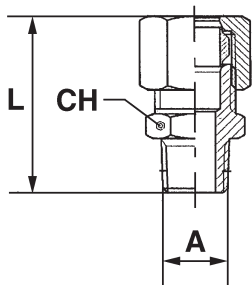
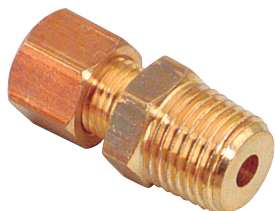

TYPE	TUBE	A	L	CH
CODE				
1300 04 10	4	1/8	26,5	11
1300 04 13	4	1/4	29,5	14
1300 06 10	6	1/8	28	11
1300 06 13	6	1/4	31,5	14
1300 06 17	6	3/8	32	17
1300 08 10	8	1/8	30	13
1300 08 13	8	1/4	33,5	14
1300 08 17	8	3/8	34	17
1300 10 13	10	1/4	36	16
1300 10 17	10	3/8	36,5	17
1300 10 21	10	1/2	38	21
1300 12 13	12	1/4	37	18
1300 12 17	12	3/8	37,5	18
1300 12 21	12	1/2	39	21
1300 14 17	14	3/8	37,5	20
1300 14 21	14	1/2	40	21
1300 15 21	15	1/2	40	21
1300 16 21	16	1/2	42,5	22
1300 16 27	16	3/4	44	27
1300 18 21	18	1/2	43,5	24
1300 18 27	18	3/4	45	27
1300 22 21	22	1/2	46	30
1300 22 27	22	3/4	47,5	30

DROIT FEMELLE CYLINDRIQUE

FEMALE STRAIGHT FITTING, PARALLEL

MANOMETERVERSCHRAUBUNG

1303

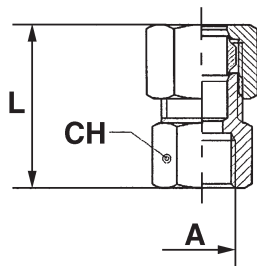
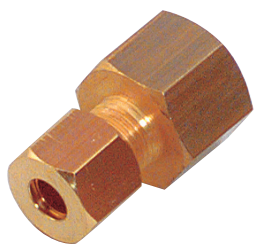

TYPE	TUBE	A	L	CH
CODE				
1303 04 10	4	1/8	25	14
1303 04 13	4	1/4	27,5	17
1303 06 10	6	1/8	26	14
1303 06 13	6	1/4	28,5	17
1303 08 10	8	1/8	28	14
1303 08 13	8	1/4	30,5	17
1303 08 17	8	3/8	31,5	20
1303 10 13	10	1/4	33	17
1303 10 17	10	3/8	33,5	20
1303 10 21	10	1/2	35,5	24
1303 12 13	12	1/4	34	18
1303 12 17	12	3/8	34,5	20
1303 12 21	12	1/2	34	24
1303 14 17	14	3/8	36,5	20
1303 14 21	14	1/2	39	24
1303 15 21	15	1/2	36,5	24
1303 16 21	16	1/2	39	24
1303 16 27	16	3/4	40,5	30
1303 18 21	18	1/2	40	24
1303 18 27	18	3/4	41,5	30
1303 22 27	22	3/4	41,5	30

ÉQUERRE MÂLE CONIQUE

ELBOW MALE FITTING, TAPER

WINKEL EINSCHRAUBVERSCHRAUBUNG - KEGELIG

1310

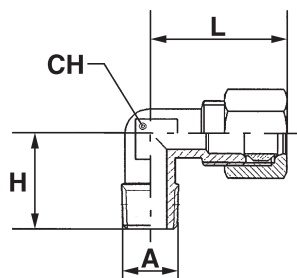
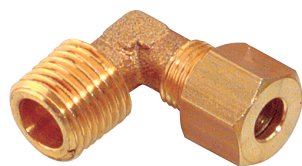

TYPE	TUBE	A	H	L	CH
CODE					
1310 04 10	4	1/8	15	21,5	8
1310 06 10	6	1/8	17	26	9
1310 06 13	6	1/4	19	24	9
1310 08 10	8	1/8	18	30	11
1310 08 13	8	1/4	21,5	30	11
1310 08 17	8	3/8	24	30,5	13
1310 10 13	10	1/4	23,5	33	13
1310 10 17	10	3/8	24,5	33	13
1310 10 21	10	1/2	25	35	14
1310 12 13	12	1/4	24	36	14
1310 12 17	12	3/8	26	36	14
1310 12 21	12	1/2	25	36	14
1310 14 17	14	3/8	26	39	17
1310 14 21	14	1/2	28,5	39	17
1310 15 21	15	1/2	28,5	39	17
1310 16 21	16	1/2	28	40	17
1310 18 21	18	1/2	29,5	41,5	20
1310 18 27	18	3/4	32	41,5	20
1310 22 27	22	3/4	34	44,5	27

ÉQUERRE FEMELLE CYLINDRIQUE

ELBOW FEMALE FITTING, PARALLEL

WINKELAUFSCHRAUBVERSCHRAUBUNG - ZYLINDRISCH

1304

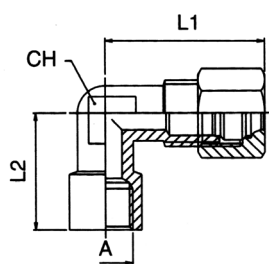
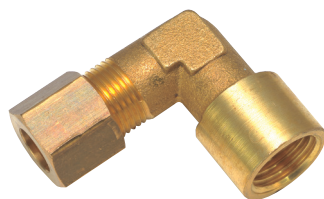

TYPE	TUBE	A	L1	L2	CH
CODE					
1304 04 10	4	1/8	23	18	8
1304 06 10	6	1/8	24	18	9
1304 06 13	6	1/4	24,5	22,5	11
1304 08 10	8	1/8	30	21	11
1304 08 13	8	1/4	30,5	25,5	13
1304 08 17	8	3/8	31	25	14
1304 10 13	10	1/4	34	25	13
1304 10 17	10	3/8	34	25	14
1304 10 21	10	1/2	34	27	15
1304 12 13	12	1/4	36	26	14
1304 12 17	12	3/8	36	26	14
1304 12 21	12	1/2	36	27	15
1304 14 21	14	1/2	39	30	18
1304 15 21	15	1/2	39	30	18
1304 16 21	16	1/2	41,5	30	18
1304 18 21	18	1/2	41,5	29	20
1304 18 27	18	3/4	44,5	33,5	20

Raccords d'implantation

Implantation's fittings

Einschraub-Steckverschraubungen

RACCORD EN T PIQUAGE CENTRAL MÂLE CONIQUE

CENTRAL T MALE FITTING, TAPER

ZENTRALE T-EINSCHRAUBVERSCHRAUBUNG - KEGELIG

1308

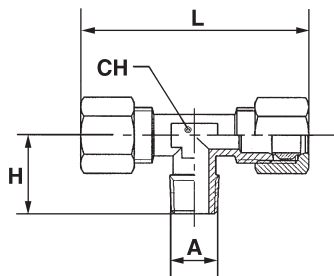
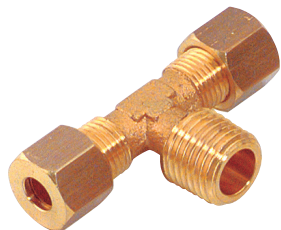

TYPE	TUBE	A	H	L	CH
CODE					
1308 04 10	4	1/8	15	45	8
1308 06 10	6	1/8	16,5	48	9
1308 06 13	6	1/4	20,5	48	9
1308 08 10	8	1/8	16,5	57	12
1308 08 13	8	1/4	20,5	57	12
1308 08 17	8	3/8	23	61	13
1308 10 13	10	1/4	22,5	64	13
1308 10 17	10	3/8	23,5	64	13
1308 10 21	10	1/2	27	68	14
1308 12 13	12	1/4	24,5	69	14
1308 12 17	12	3/8	25	69	14
1308 12 21	12	1/2	26,5	69	14
1308 14 17	14	3/8	26	74	16
1308 14 21	14	1/2	31	77	18
1308 15 21	15	1/2	31	77	18
1308 16 21	16	1/2	29	78	17
1308 18 21	18	1/2	29,5	83	20
1308 18 27	18	3/4	32,5	83	20
1308 22 27	22	3/4	34	89	27

RACCORD EN T PIQUAGE EN BOUT MÂLE CONIQUE

LATERAL T MALE FITTING, TAPER

LATERALE T-EINSCHRAUBVERSCHRAUBUNG - KEGELIG

1312

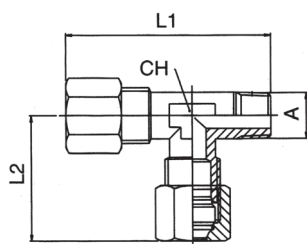
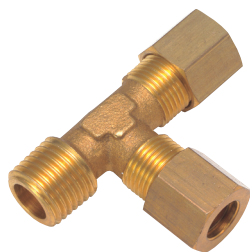

TYPE	TUBE	A	L1	L2	CH
CODE					
1312 04 10	4	1/8	37,5	22,5	8
1312 06 10	6	1/8	40	25	9
1312 06 13	6	1/4	44	24	9
1312 08 10	8	1/8	45,5	28,5	12
1312 08 13	8	1/4	49	28,5	12
1312 08 17	8	3/8	52	28,5	13
1312 10 13	10	1/4	55	32	13
1312 10 17	10	3/8	55,5	32	13
1312 12 17	12	3/8	58,5	35	14
1312 12 21	12	1/2	60	35,5	15
1312 14 21	14	1/2	67	38,5	18

RACCORD EN T PIQUAGE CENTRAL FEMELLE CYLINDRIQUE

FEMALE T T FITTING, PARALLEL

T-AUFSCHRAUBVERSCHRAUBUNG-ZYLINDRISCH

1341

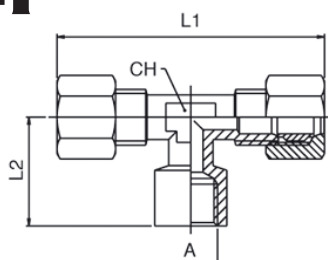

TYPE	TUBE	A	L1	L2	CH
CODE					
1341 04 10	4	1/8	45	18	8
1341 06 10	6	1/8	47,5	19,5	9
1341 06 13	6	1/4	56	24,5	13
1341 08 10	8	1/8	57	19,5	12
1341 08 13	8	1/4	59	24,5	13
1341 10 13	10	1/4	64	24,5	13
1341 10 17	10	3/8	58	26	14
1341 12 21	12	1/2	70	26	15

DROIT MÂLE CYLINDRIQUE

MALE STRAIGHT FITTING, PARALLEL
 GERADE EINSCHRAUBVERSCHRAUBUNG - ZYLINDRISCH

1301

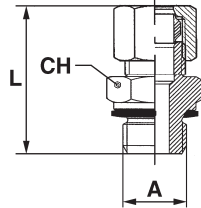

TYPE	TUBE	A	L	CH
CODE				
1301 04 10	4	1/8	26	13
1301 06 10	6	1/8	27	13
1301 06 13	6	1/4	30,5	17
1301 08 10	8	1/8	30	13
1301 08 13	8	1/4	32,5	17
1301 08 17	8	3/8	36,5	22
1301 10 13	10	1/4	35	17
1301 10 17	10	3/8	39	22
1301 14 17	14	3/8	40	22
1301 14 21	14	1/2	42	27
1301 22 27	22	3/4	49	32
1301 22 34	22	1"	52	40

RACCORD BANJO SIMPLE

SINGLE BANJO FITTING
 SCHWENK-RINGSTÜCK-EINFACH

1306

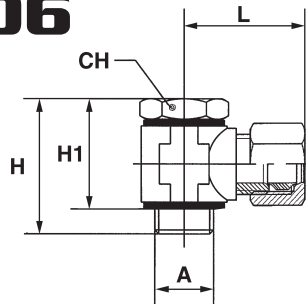
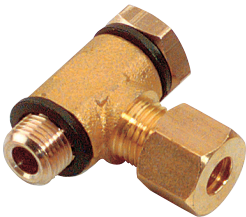

TYPE	TUBE	A	H	H1	L	CH
CODE						
1306 04 10	4	1/8	31	24,5	22,5	14
1306 06 10	6	1/8	31	24,5	23,5	14
1306 06 13	6	1/4	32	25	26,5	17
1306 08 10	8	1/8	31	24,5	28,5	14
1306 08 13	8	1/4	32	25	28,5	17
1306 08 17	8	3/8	36	27,5	30	19
1306 10 13	10	1/4	32	25	32,5	17
1306 10 17	10	3/8	36	27,5	32,5	19
1306 14 13	14	1/4	44	38	37	17
1306 14 17	14	3/8	46	38	37	22
1306 14 21	14	1/2	49	39,5	37	24
1306 22 27	22	3/4	64	55	47	32

EQUERRE MÂLE ORIENTABLE CYLINDRIQUE

SWIVEL MALE ELBOW FITTING, PARALLEL
 WINKEL-EINSCHRAUBVERSCHRAUBUNG, SCHWENKBAR, ZYLINDRISCH

1326

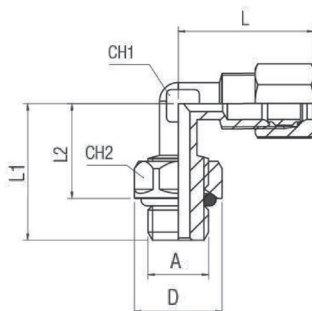

- 20°C ÷ 80°C

TYPE	TUBE	A	L	L1	L2	D	CH1	CH2
CODE								
1326 04 10	4	1/8	23	22,5	15,5	15	9	14
1326 04 13	4	1/4	23	30	19	19	9	17
1326 06 10	6	1/8	24,5	23	15,5	15	9	14
1326 06 13	6	1/4	24	21	19	19	9	17
1326 08 10	8	1/8	29	23	15,5	15	9	14
1326 08 13	8	1/4	29	29,5	19	19	9	17
1326 08 17	8	3/8	29,5	30,5	19	22	13	20
1326 10 13	10	1/4	32,5	30	19	19	13	17
1326 10 17	10	3/8	32,5	30,5	19	22	13	20
1326 10 21	10	1/2	33,5	39	24	25	17	23
1326 14 17	14	3/8	38,5	33,5	19	22	17	20
1326 14 21	14	1/2	38,5	39	24	25	17	23
1326 18 21	18	1/2	41,5	39,5	24	25	20	23
1326 18 27	18	3/4	41,5	42	25,5	32	20	30

Raccords de jonction

Junction's fittings

Verbindungsverschraubungen

DROIT DOUBLE

INTERMEDIATE STRAIGHT FITTING
GERADER VERBINDER

1302

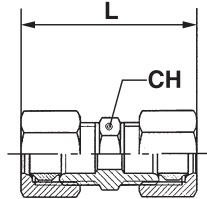
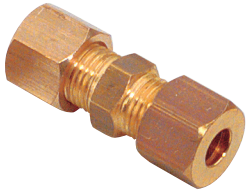

TYPE CODE	TUBE	L	CH
1302 04 00	4	33	10
1302 06 00	6	36	11
1302 08 00	8	40	13
1302 10 00	10	45,5	16
1302 12 00	12	47	18
1302 14 00	14	47,5	21
1302 15 00	15	52	21
1302 16 00	16	52,5	22
1302 18 00	18	56	26
1302 22 00	22	58,5	30

ÉQUERRE DOUBLE

INTERMEDIATE ELBOW FITTING
WINKELVERBINDER

1307

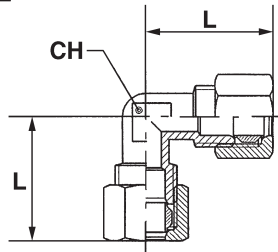
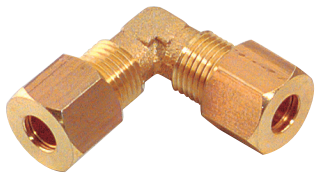

TYPE CODE	TUBE	L	CH
1307 04 00	4	21,5	8
1307 06 00	6	24	9
1307 08 00	8	30	11
1307 10 00	10	33	13
1307 12 00	12	36	14
1307 14 00	14	37	17
1307 15 00	15	38	17
1307 16 00	16	39,5	17
1307 18 00	18	41,5	20
1307 22 00	22	44,5	27

RACCORD EN T TRIPLE

INTERMEDIATE T FITTING
T-VERSCHRAUBUNG

1314

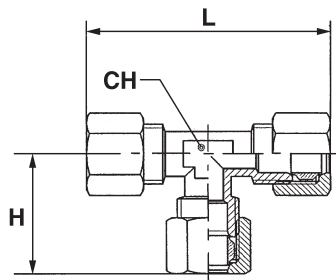
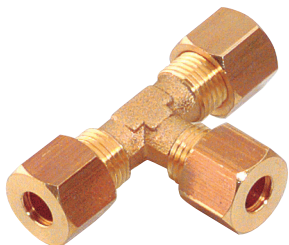

TYPE CODE	TUBE	H	L	CH
1314 04 00	4	22	44	8
1314 06 00	6	24	48	9
1314 08 00	8	28,5	57	12
1314 10 00	10	32	64	13
1314 12 00	12	35	69	14
1314 14 00	14	39	78	18
1314 15 00	15	38,5	77	18
1314 16 00	16	39,5	78,5	17
1314 18 00	18	41,5	83	20
1314 22 00	22	44,5	89	27

RACCORD EN CROIX
 INTERMEDIATE CROSS FITTING
 KREUZVERBINDER

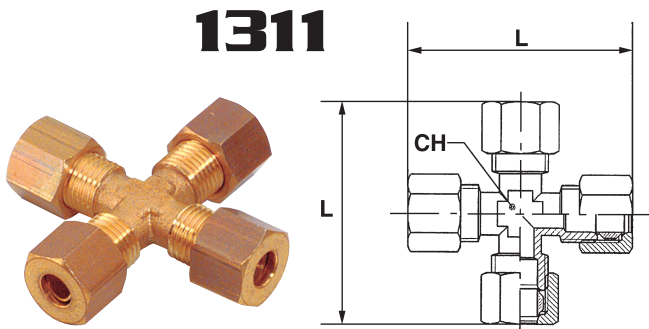

TYPE	TUBE	L	CH
CODE			
1311 04 00	4	47	8
1311 06 00	6	48	9
1311 08 00	8	58	11
1311 10 00	10	66	13
1311 12 00	12	74	17
1311 14 00	14	74	17

TRAVERSÉE DE CLOISON DOUBLE
 INTERMEDIATE BULKHEAD FITTING
 SCHOTT-VERSCHRAUBUNG

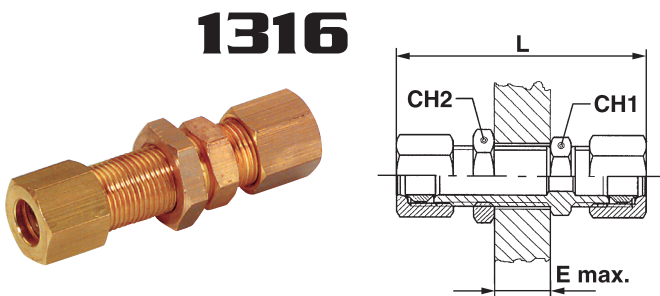

TYPE	TUBE	L	E max	CH1	CH2
CODE					
1316 04 00	4	49	12	10	13
1316 06 00	6	53	12,5	13	14
1316 08 00	8	57	12,5	14	17
1316 10 00	10	64	13	19	22
1316 12 00	12	70	17	22	22
1316 14 00	14	72	19	24	24

Accessoires
Accessories
Zubehör

RÉDUCTION
 REDUCER
 REDUZIERUNG

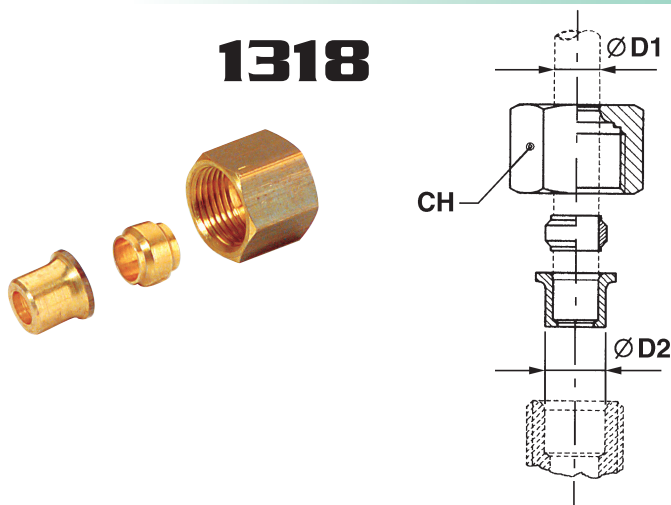

TYPE	D1	D2	CH
CODE			
1318 04 06	4	6	13
1318 06 08	6	8	14
1318 08 10	8	10	19
1318 10 12	10	12	22
1318 12 14	12	14	24

BOUCHON

PLUG
 STOPFEN

1320

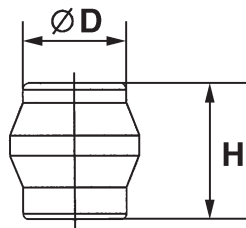

TYPE	TUBE(D)	H
CODE		
1320 04 00	4	10
1320 06 00	6	10,5
1320 08 00	8	10,5
1320 10 00	10	11,5
1320 12 00	12	12
1320 14 00	14	14
1320 15 00	15	14
1320 16 00	16	14
1320 18 00	18	16
1320 22 00	22	15

BAGUE

OGIVE SEAL
 SCHNEIDRING

1329

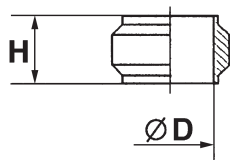

TYPE	TUBE(D)	H
CODE		
1329 04 00	4	6
1329 06 00	6	6,5
1329 08 00	8	7
1329 10 00	10	8
1329 12 00	12	8,5
1329 14 00	14	8,5
1329 15 00	15	8,5
1329 16 00	16	9
1329 18 00	18	9,5
1329 22 00	22	10

ÉCROU DE SERRAGE

LOCKING NUT
 ÜBERWURFMUTTER

1330

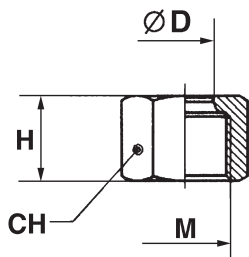

TYPE	TUBE(D)	H	CH	M
CODE				
1330 04 00	4	10,5	10	M 8x1
1330 06 00	6	10,5	13	M 10x1
1330 08 00	8	12,5	14	M 12x1
1330 10 00	10	15	19	M 16x1,5
1330 12 00	12	15	22	M 18x1,5
1330 14 00	14	15	24	M 20x1,5
1330 15 00	15	15	24	M 20x1,5
1330 16 00	16	17	27	M 22x1,5
1330 18 00	18	18	30	M 24x1,5
1330 22 00	22	19	36	M 30x1,5

FOURRURE INTÉRIEURE

FERRULE
VERSTÄRKUNGSHÜLSE

1331

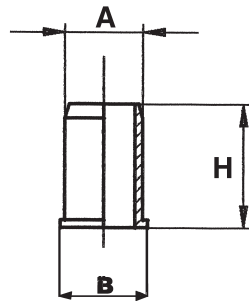

TYPE	TUBE	A	B	H
CODE				
1331 04 00	4/2,7	2,7	3,8	13
1331 06 00	6/4	4	5	13
1331 08 00	8/6	6	7	16,5
1331 10 00	10/8	8	9	17
1331 12 00	12/10	10	11	19
1331 14 00	14/12	12	13,5	21
1331 15 00	15/12,5	12,5	14	21
1331 16 00	16/13	13	15,5	22
1331 22 00	22/18	18	21	25

ADAPTATEUR POUR TUBE SOUPLE

FLEXIBLE HOSE ADAPTOR
ADAPTER FÜR BIEGSAME SCHLAÜCHE

1335

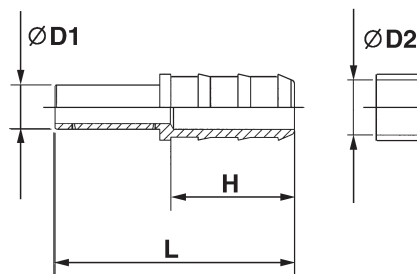
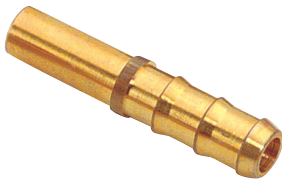

TYPE	D1	D2	H	L
CODE				
1335 06 07	6	7	22,5	40,5
1335 08 07	8	7	22,5	43,5
1335 08 10	8	10	22,5	43,5
1335 10 07	10	7	22,5	44,5
1335 10 10	10	10	22,5	44,5
1335 12 10	12	10	22,5	45
1335 12 13	12	13	29,5	52
1335 14 13	14	13	29,5	52,5

ADAPTATEUR POUR TUBE SOUPLE

FLEXIBLE HOSE ADAPTOR
ADAPTER FÜR BIEGSAME SCHLAÜCHE

1359

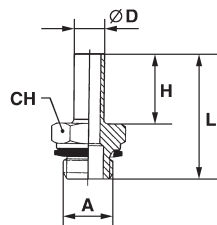
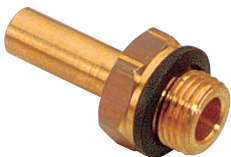

TYPE	TUBE(D)	A	H	L	CH
CODE					
1359 06 10	6	1/8	16	27,5	13
1359 06 13	6	1/4	16	31	17
1359 08 10	8	1/8	19	31,5	13
1359 08 13	8	1/4	19	34	17
1359 08 17	8	3/8	19	38	22
1359 10 13	10	1/4	20	35	17
1359 10 17	10	3/8	20	39	22
1359 14 17	14	3/8	21	40	22
1359 14 21	14	1/2	21	42	27

RONDELLE BI-MATIÈRE ACIER - NBR

STEEL AND NBR BIMATERIAL WASHER
VERBUNDDICHTRING AUS STAHL UND NBR

1190

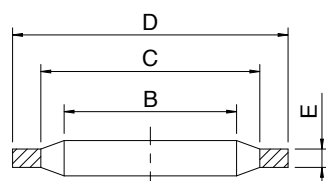

TYPE	A	B	C	D	E
CODE					
1190 10 00	1/8	10,4	12	14,7	1,25
1190 13 00	1/4	13,85	15,75	18,7	1,25
1190 17 00	3/8	17,35	19,25	22,7	1,25
1190 21 00	1/2	21,65	23,55	26,7	1,25
1190 27 00	3/4	27,3	29,2	32,5	1,25
1190 34 00	1"	34,2	36,1	39,5	2

DOUILLE ANNELEE FEMELLE TOURNANT POUR TUYAUX AUTO-SERRANTS

FEMALE HOSE ADAPTER FOR PUSH-LOCK HOSES

SCHNELLSTECKTÜLE FÜR UNIVERSAL-Verschraubungen

1350

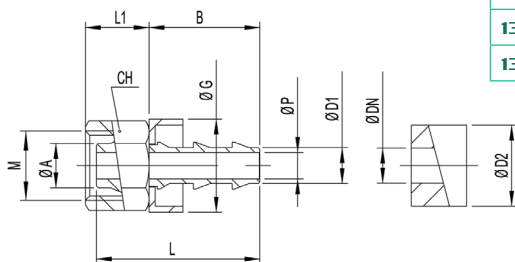

TYPE	A	DN	D1	D2	CH	G	L	B	L1	P	M
CODE											
1350 06 06	6	1/4	6,5	13	12	16,7	32,5	20	11,5	4,8	M10x1
1350 08 06	8	1/4	6,5	13	14	16,7	29,5	20	12,5	4,8	M12x1
1350 10 06	10	1/4	6,5	13	19	16,7	30,5	24	14	4,8	M16x1,5
1350 10 08	10	3/8	9,5	16	19	19,5	34,5	24	14	7,5	M16x1,5
1350 14 08	14	3/8	9,5	16	24	19,5	36	28	15	7,5	M20x1,5
1350 14 12	14	1/2	12,7	19	24	23,5	40	28	15	10	M20x1,5
1350 18 12	18	1/2	12,7	19	30	23,5	40,5	36,5	17	10	M24x1,5
1350 18 16	18	5/8	15,7	23	30	27,3	49	36,5	17	13,5	M24x1,5
1350 22 20	22	3/4	18,8	27	36	30,8	57,5	43	17	16	M30x1,5

DOUILLE ANNELEE MÂLE CYLINDRIQUE POUR TUYAUX AUTO-SERRANTS

MALE HOSE ADAPTER FOR PUSH-LOCK HOSES

EINSCHRAUBTÜLE FÜR SCHNELLSTECKSCHLÄUCHE

1351

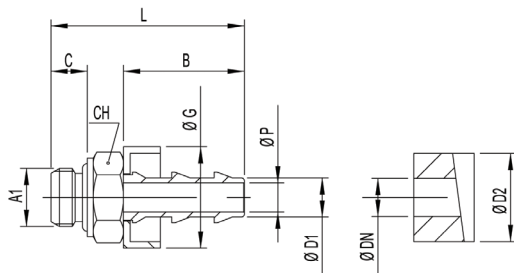

TYPE	A1	DN	D1	D2	CH	G	L	B	L1	P
CODE										
1351 06 10	G1/8	1/4	6,5	13	13	16,7	32	20	6	4,8
1351 06 13	G1/4	1/4	6,5	13	17	16,7	35,5	20	8	4,8
1351 08 13	G1/4	3/8	9,5	16	17	19,5	39,5	24	8	7,5
1351 08 17	G3/8	3/8	9,5	16	22	19,5	41	24	9	7,5
1351 12 17	G3/8	1/2	12,7	19	22	23,5	45	28	9	10
1351 12 21	G1/2	1/2	12,7	19	27	23,5	47	28	10	10
1351 16 21	G1/2	5/8	15,7	23	27	27,3	55	36,5	10	13,5
1351 16 27	G3/4	5/8	15,7	23	32	27,3	58,5	36,5	12	13,5
1351 20 27	G3/4	3/4	18,8	27	32	30,8	65	43	12	16

Tuyaux auto-serrants : voir page N I I
 Push-lock hoses : see page N I I
 Schnellsteckschläuche : siehe Seite N I I