

# Silencieux d'échappement

## Air silencers

## Schalldämpfer

### Champs d'application : air comprimé

Caractéristiques techniques

- filetages : mâle cylindrique BSP  
mâle NPT
- pression d'exercice : 0 - 12 bar
- température de travail :  $-10^{\circ} \div 80^{\circ}\text{C}$

### Areas of application : compressed air

Technical features

- threads : male parallel BSP  
male NPT
- working pressure : 0 - 12 bar
- working temperature :  $-10^{\circ} \div 80^{\circ}\text{C}$

### Anwendungsbereiche : Druckluft

Technische Daten

- Gewinde : zylindrisches Außen BSP  
Außen NPT
- Betriebsdruck : 0 - 12 bar
- Betriebstemperatur :  $-10^{\circ} \div 80^{\circ}\text{C}$

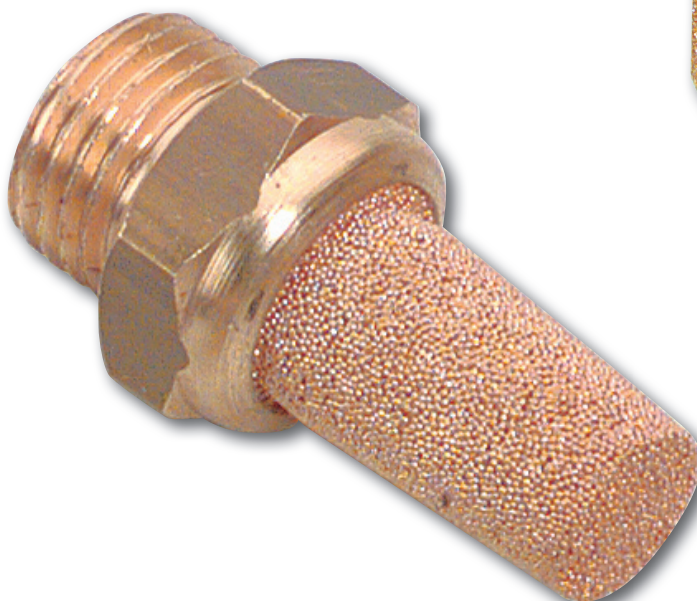
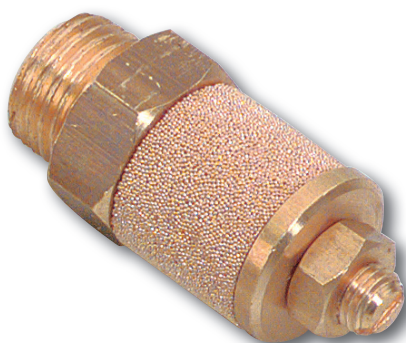

Airfit

# Silencieux d'échappement

## Air silencers

## Schalldämpfer

### SILENCIEUX EMBASE EN LAITON, CORPS EN BRONZE FRITTÉ

SINTERED BRONZE AIR SILENCER  
SCHALLDÄMPFER AUS SINTERBRONZE

# 2900



1/8" femelle

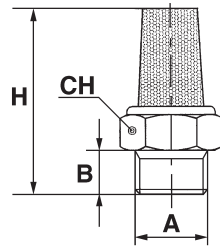

TYPE	A	B	H	CH
<b>CODE</b>				
2900 05 00	M5	4	22	8
2900 07 00	M7	5	21	10
2900 10 00	1/8	6	27	13
2900 11 00	1/8 NPT	6	27	13
2900 13 00	1/4	8	32	16
2900 14 00	1/4 NPT	11	35	16
2900 17 00	3/8	8	41	19
2900 21 00	1/2	10	52	24
2900 27 00	3/4	10	54	30
2900 34 00	1"	11	66	36
2900 10 30	1/8 F	6	29	13

### SILENCIEUX EMBASE EN LAITON, PASTILLE EN BRONZE FRITTÉ

SINTERED BRONZE AIR SILENCER  
SCHALLDÄMPFER AUS SINTERBRONZE

# 2902

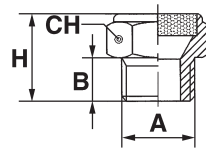

TYPE	A	B	H	CH
<b>CODE</b>				
2902 05 00	M5	5	12	8
2902 10 00	1/8	6	14	13
2902 13 00	1/4	7	17	16
2902 17 00	3/8	8	18	19
2902 21 00	1/2	10	19	24
2902 27 00	3/4	10	19	30
2902 34 00	1"	12	22	36

### SILENCIEUX EMBASE EN LAITON, CORPS EN BRONZE FRITTÉ, AVEC CARRÉ DE SERRAGE

SINTERED BRONZE AIR SILENCER  
SCHALLDÄMPFER AUS SINTERBRONZE

# 2905

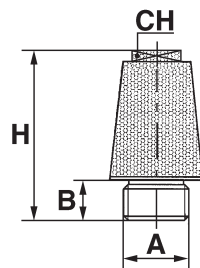

TYPE	A	B	H	CH
<b>CODE</b>				
2905 10 00	1/8	6	21	7
2905 13 00	1/4	7	26	8
2905 17 00	3/8	8	38	10
2905 21 00	1/2	10	41	14
2905 27 00	3/4	10	54	17
2905 34 00	1"	15	63	23

### SILENCIEUX À ENCASTRER

PAD SILENCER WITH SLOT FOR SCREWDRIVER  
SCHALLDÄMPFER MIT SCHLITZ FÜR SCHRAUBENDREHER

# 2909

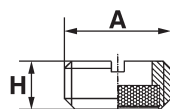

TYPE	A	H
<b>CODE</b>		
2909 10 00	1/8	5
2909 13 00	1/4	6
2909 17 00	3/8	7
2909 21 00	1/2	8
2909 27 00	3/4	9

**SILENCIEUX EMBASE LAITON, FIL EN ACIER INOXYDABLE**

BRASS AIR SILENCER, STAINLESS STEEL WIRE  
SCHALLDÄMPFER AUS MESSING, INOX STAHLDRAHT

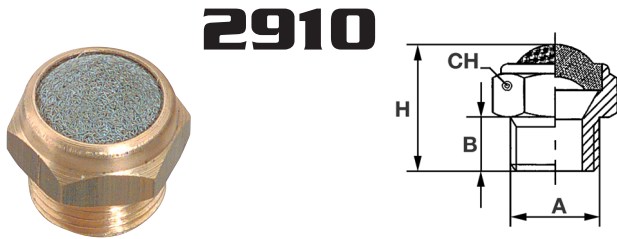

TYPE	A	B	H	CH
<b>CODE</b>				
2910 05 00	M5	4	8	8
2910 10 00	1/8	6	15	13
2910 13 00	1/4	7	18	16
2910 14 00	1/4 NPT	10	21	16
2910 17 00	3/8	8	20	19
2910 21 00	1/2	10	22	24
2910 27 00	3/4	10	26	30
2910 34 00	1"	12	28	36

**SILENCIEUX EMBASE NYLON, FIL EN ACIER INOXYDABLE**

NYLON AIR SILENCER, STAINLESS STEEL WIRE  
SCHALLDÄMPFER AUS NYLON, INOX STAHLDRAHT

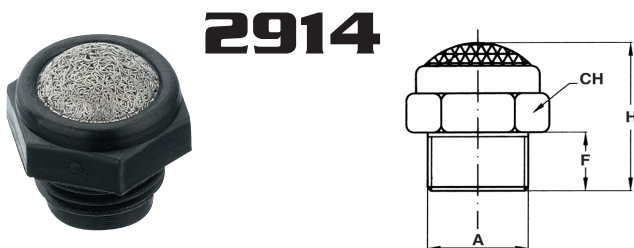

TYPE	A	F	H	CH
<b>CODE</b>				
2914 10 00	1/8	6	15	13
2914 13 00	1/4	7	18	16
2914 17 00	3/8	8	20	19
2914 21 00	1/2	10	22	24

**SILENCIEUX AUTONETTOYANT EN RÉSINE**

DYNAMIC SILENCER  
DYNAMISCHER SCHALLDÄMPFER



TYPE	A	B	H	L
<b>CODE</b>				
2920 10 00	1/8	6	32,5	15
2920 13 00	1/4	8	43	19,5
2920 17 00	3/8	11	58	24,5
2920 21 00	1/2	11	58	24,5
2920 27 00	3/4	18	115	48
2920 34 00	1"	18	115	48

**SILENCIEUX STATIQUE EN RÉSINE**

PLASTIC AIR SILENCER  
SCHALLDÄMPFER AUS NYLON



TYPE	A	B	H	L	CH
<b>CODE</b>					
2925 10 00	1/8	6	33	15,5	10
2925 13 00	1/4	8	43	19,5	12
2925 17 00	3/8	11	58	24,5	16
2925 21 00	1/2	11	58	24,5	16

# Silencieux d'échappement

## Air silencers

## Schalldämpfer

### SILENCIEUX AVEC RÉGULATEUR D'ÉCHAPPEMENT

ADJUSTABLE SILENCER

EINSTELLBARER SCHALLDÄMPFER

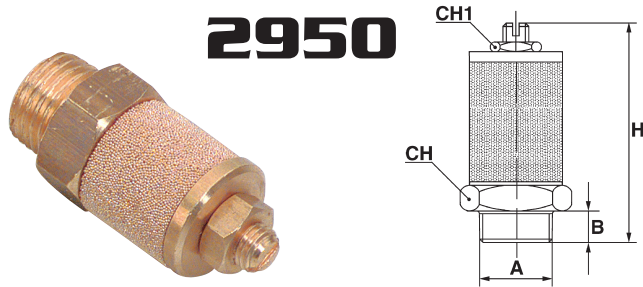

# 2950

sur demande : existe en version inox AISI 316L du M5 au 1/4"

TYPE	A	B	Hmin	Hmax	CH	CH1
<b>CODE</b>						
2950 05 00	M5	3,5	13	18	6	8
2950 10 00	1/8	8	38	44	16	10
2950 13 00	1/4	9	39	45	16	10
2950 17 00	3/8	10	47	60	22	10
2950 21 00	1/2	11	48	61	22	10
2950 27 00	3/4	11	68	92	30	13
2950 34 00	1"	11	68	92	36	13

### SILENCIEUX AVEC RÉGULATEUR D'ÉCHAPPEMENT

ADJUSTABLE SILENCER

EINSTELLBARER SCHALLDÄMPFER

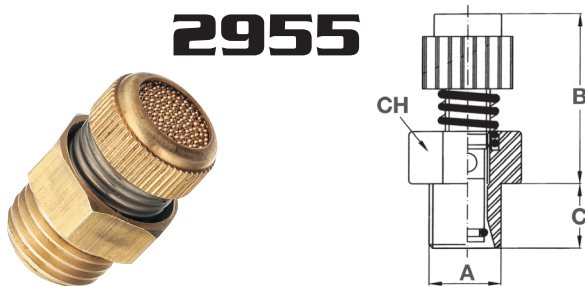

# 2955

sur demande : existe en version inox AISI 316L du M5 au 1/4"

TYPE	A	B min	B max	C	CH
<b>CODE</b>					
2955 10 00	1/8	14	19	6	12
2955 13 00	1/4	17	22	8	15
2955 17 00	3/8	18	24	9	19
2955 21 00	1/2	18	24	10,5	22

### SILENCIEUX TOUT INOX

STAINLESS STEEL SILENCER

SCHALLDÄMPFER AUS EDELSTAHL

**INOX**

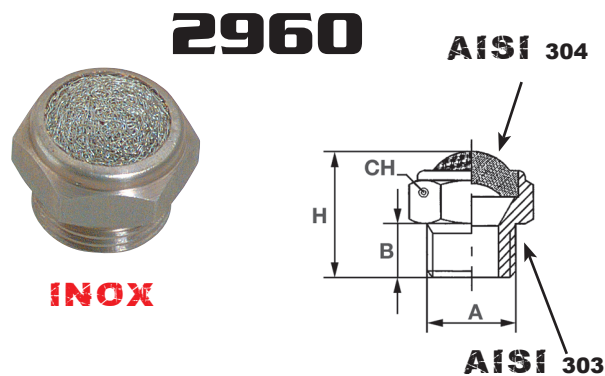

# 2960

AISI 304

**INOX**

AISI 303

TYPE	A	B	H	CH
<b>CODE</b>				
2960 05 00	M5	3,5	8	8
2960 10 00	1/8	6	15	13
2960 11 00	1/8 NPT	10	18	13
2960 13 00	1/4	7	18	16
2960 14 00	1/4 NPT	14	25	16
2960 17 00	3/8	8	20	19
2960 21 00	1/2	10	22	24
2960 27 00	3/4	10	26	30
2960 34 00	1"	12	28	36

### SILENCIEUX EN ALUMINIUM

ALUMINIUM SILENCER

SCHALLDÄMPFER AUS ALUMINIUM

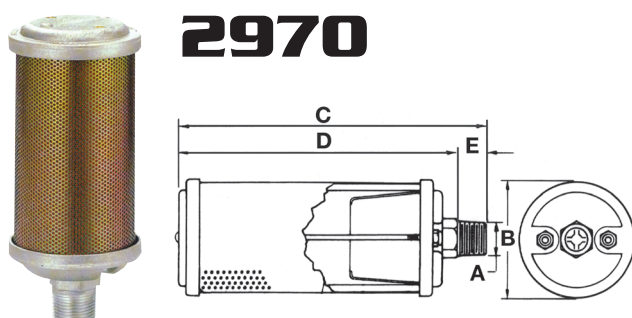

# 2970

TYPE	A	B	C	D	E
<b>CODE</b>					
2970 17 00	3/8	70	126	113	16
2970 21 00	1/2	86	146	132	13
2970 27 00	3/4	89	179	162	17
2970 34 00	1"	103	219	192	26
2970 42 00	1"1/4	103	219	192	26
2970 49 00	1"1/2	136	351	318	33
2970 60 00	2"	136	484	450	33

**SILENCIEUX EN POLYÉTHYLÈNE**

POLYETHYLENE SILENCER  
SCHALLDÄMPFER AUS POLYÄTHYLEN



**2922**

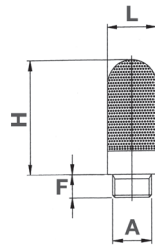

TYPE	A	F	H	L
<b>CODE</b>				
2922 05 00	M5	4	19	7
2922 10 00	1/8	6	28	13
2922 13 00	1/4	8	31	17
2922 17 00	3/8	11	54	25
2922 21 00	1/2	11	58,5	25
2922 27 00	3/4	18	122,5	37
2922 34 00	1"	18	138,5	48

**SILENCIEUX EN POLYÉTHYLÈNE ENCLIQUETABLE**

POLYETHYLENE SILENCER WITH PLUG  
SCHALLDÄMPFER AUS POLYÄTHYLEN MIT STECKNIPPEL



**2923**

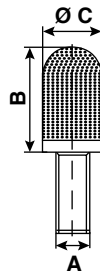

TYPE	A	B	C
<b>CODE</b>			
2923 06 00	6	45	12,5
2923 08 00	8	43,5	13,5
2923 10 00	10	57,5	15,5
2923 12 00	12	82	18,5

**SILENCIEUX EN ACIER ZINGUÉ (cartouche en acier inoxydable)**

ZINC-PLATED SILENCER (cartridge: stainless steel)  
SCHALLDÄMPFER AUS STAHLVERZINKT (Filtersatz aus Edelstahl)



**2975**

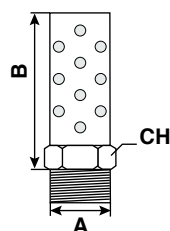

TYPE	A	B	CH
<b>CODE</b>			
2975 10 00	1/8	28	11
2975 13 00	1/4	33	14
2975 17 00	3/8	43	18
2975 21 00	1/2	52	22
2975 27 00	3/4	64	27
2975 34 00	1"	76	33

**SILENCIEUX-FILTRE EN LIGNE F/F, FILTRE EN BRONZE NICKELÉ**

FILTER-SILENCER F/F, LINEVERSION, NICKEL PLATED BRONZE  
FILTERSCHALLDÄMPFER, EINREIHIGE AUSFÜHRUNG, FILTER AUS BRONZE VERNICKELT

**2980**

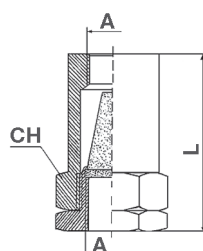

TYPE	A	L	CH
<b>CODE</b>			
2980 10 00	1/8	35	17
2980 13 00	1/4	41	19
2980 17 00	3/8	53	24
2980 21 00	1/2	63	30

